



TWELVE

User Guide	English (3–8)
Guía del usuario	Español (9–14)
Guide d'utilisation	Français (15–20)
Guida per l'uso	Italiano (21–26)
Benutzerhandbuch	Deutsch (27–32)
Appendix	English (34)

RANE

User Guide (English)

Introduction

Thank you for purchasing the Twelve. At Rane DJ, we know how serious music is to you. That's why we design our equipment with only one thing in mind—to make your performance the best it can be.

The Twelve is a pure and powerful motorized DJ control system. Keeping things consistent with a familiar turntable layout and size in an all-metal body, the only clear differentiator is a precision, multi-function touch strip for track searching and setting or triggering hot cues in place of the tone arm.

Designed with the DJ in mind, the Twelve lets you scratch and play with the feel of a traditional turntable, but with the precision, repeatability and durability of the best digitally-based solutions.

Box Contents

Twelve Base
Platter Assembly
 Aluminum Platter
 Slipmat
 Control Disc with Quick Release Adapter (attached)
 Spacers (4)
Power Cable
USB Cable
User Guide
Safety & Warranty Manual

Note: Twelve was designed in collaboration with Serato, making it an Official Serato Accessory. Twelve requires a supported Serato DJ Pro interface, controller, mixer, or compatible Serato Club Kit solution to control Serato DJ Pro.

Support

For the latest information about this product (documentation, technical specifications, system requirements, compatibility information, etc.) and product registration, visit dj.rane.com.

For additional product support, visit dj.rane.com/support.

Setup

Before getting started:

Read the Safety & Warranty Manual before using Twelve.

Make sure all items listed in [Introduction](#) [Box Contents](#) are included. Items not listed are sold separately.

1. Assemble the Platter System

1. Remove the Twelve base from the packaging. Remove the platter assembly from the package (underneath Twelve). Place Twelve on a flat, stable surface for assembly and operation.

2. Place the platter onto the Twelve base by aligning the pins in the bottom of the platter with the holes in Twelve's motor. Press it down firmly. Check to make sure that it rotates uniformly and does not wobble excessively.

3. Place the slipmat onto the platter. Then place the **Control Disc** over the spindle (with the attached **Quick Release Adapter** on top). To lock the **Control Disc** to the spindle, pinch the top of the spindle while slowly rotating the disc until you hear it click. It locks when the groove in the spindle lines up directly opposite to the button on the side of the **Quick Release Adapter**.

Note: If you would like to adjust the slip friction of the disc, consider placing 1-4 of the included spacers over the spindle, underneath the slipmat. The more you elevate the **Control Disc** with the spacers, the more spinback you will get.

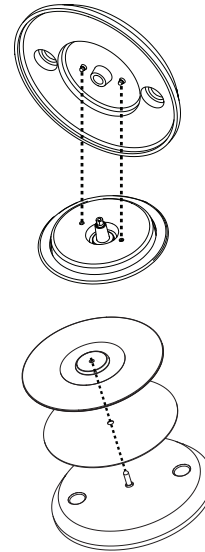

2. Connect and Start DJing!

1. Make sure you have downloaded and installed the latest version of your DJ software.
2. Place Twelve on a flat, stable surface.
3. While the power is switched off, plug the included power cable into Twelve first, then plug the cable into a power outlet.
4. Power on Twelve using the **power switch**.
5. Use a standard USB cable (included) to connect the **USB Port** to one of the following:
 - If you are using Twelve with the Rane Seventy-Two mixer (sold separately), connect the USB cable to the **Deck 1** or **Deck 2** USB ports labeled **Twelve/Controller**.
 - If you are using another mixing interface, connect the USB cable to an available USB port on your computer or a powered hub connected to the computer.
6. Open Serato DJ Pro and go! For more information on how to use Serato DJ Pro with Twelve, visit support.serato.com.

